

HOSPITALITY ENVIRONMENT

The Tudelü system offers flexibility, privacy, aesthetic customization, and improved acoustics and energy efficiency. These benefits enhance the guest experience, boost operational efficiency, and enable adaptation to various event types, making it a valuable investment for hospitality businesses.

TUDELÜ SYSTEM BENEFITS

1 Flexible Space Management

Retractable walls enable hotels and event venues to quickly adapt spaces, such as dividing a large conference room into smaller areas for different events or group sizes, offering flexibility for various gatherings.

2 Increased Privacy and Comfort

In hotels or resorts, retractable walls create temporary private spaces, enhancing the guest experience by dividing shared suites or rooms for added privacy, such as separating living and sleeping areas for families or groups.

3 Enhanced Guest Experience

Hotels and resorts can personalize guest experiences by adjusting room layouts with retractable partitions, allowing families or groups to share suites with flexible privacy, or couples to separate living and sleeping areas.

OUR SERVICES



AMERICAN

Engineering, design, and manufacture all done in the USA



MOTORIZED

100% remote controlled for zero manual effort



COMPACT

Full system has tiny footprint in ceiling, starting from 10" x 10"



INSTALLABLE

Easy install for new construction and retrofitting



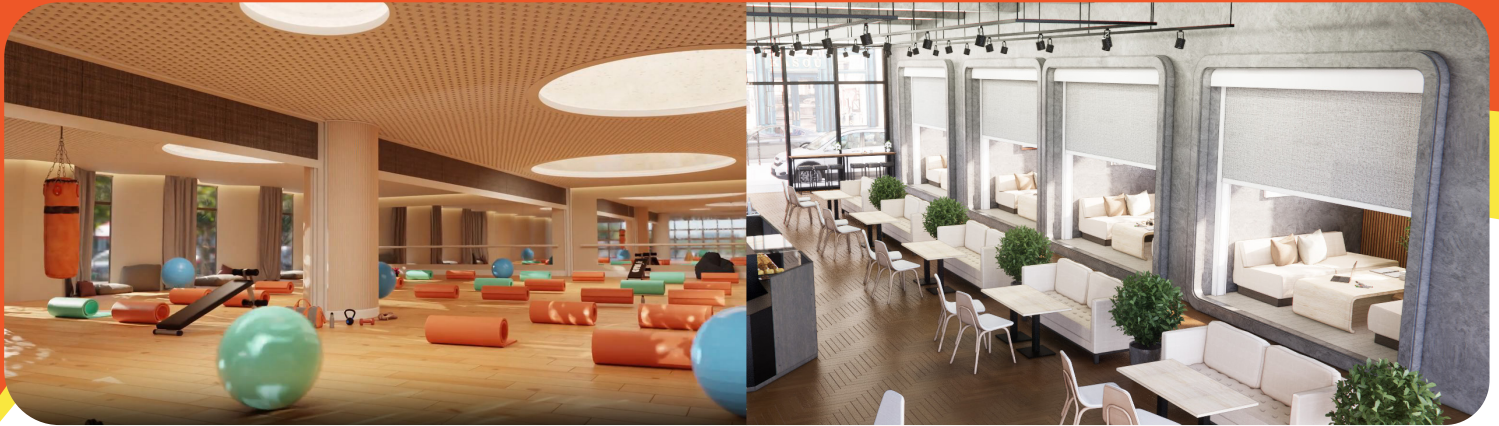

Key Benefits of the Tudelü Systems

Customizable Sizes of up to 20ft wide x 10ft tall

36 - 48 True STC sound barrier for effective sound reduction. This is the same noise reduction as traditional dry wall.

Easy Installation, either through Tudelü direct or through our step-by-step instructions.

100% Motorized - anyone can operate this product with a simple press of a button.

Durable Material - including powder coated extruded aluminum.

Patented Technology - including Stable Griprail Technology.

Compact Footprint - featuring inset design options, meaning ZERO eye sores.

Seamless Design - No matter your dimensions, Tudelü walls won't hurt your aesthetic.

Built-in Safety - auto open feature when the system feels the slightest resistance, so you and your furniture are both safe.

Easy Maintenance - simple soap and water will keep your system looking new for years to come.

Technical Information	Closure	Private	Secluded	Mute
STC of System	-	36	40	48
OTC of System	-	22	30	30
Max Height in feet	10'	10'	12'	15'
Max Width in feet	20'	20'	20'	40'
Wall Thickness in inches	2"	4"	4"	4"
Weight of Wall Fabric in lbs. (per sq. ft)	2"	4"	4"	4"
Available Fabric Choices	Various	Various	Various	Various
Framing Color	White	White	White	White
Housing Dimensions in Inches	10' x 10'	22' x 10'	22' x 10'	14' x 26'
Power Requirements	120V	120V	120V	120V
Safety Features				
Infrared Sensor	✓	✓	✓	✓
Back Up Operation When Sensor	✓	✓	✓	✓
Triggered	✓	✓	✓	✓
Additional Features				
Smart Device Integration	✓	✓	✓	✓
Modular Design for Auto-Leveling	✓	✓	✓	✓
Sealed Border	✓	✓	✓	✓
Tight Stretch Magnets	✓	✓	✓	✓
Product Finishing	Single Sided	Dual Sided	Dual Sided	Dual Sided
Quiet Open	✓	✓	✓	✓
1 Touch Remote Controlled	✓	✓	✓	✓
Patented GripRail Technology	✓	✓	✓	✓
Modular Delivery		✓	✓	✓
Smart Device Integration	✓	✓	✓	✓

